

(Endorsement on back)
 Manor of
 Springtown
 Entered page 49
 copied

31

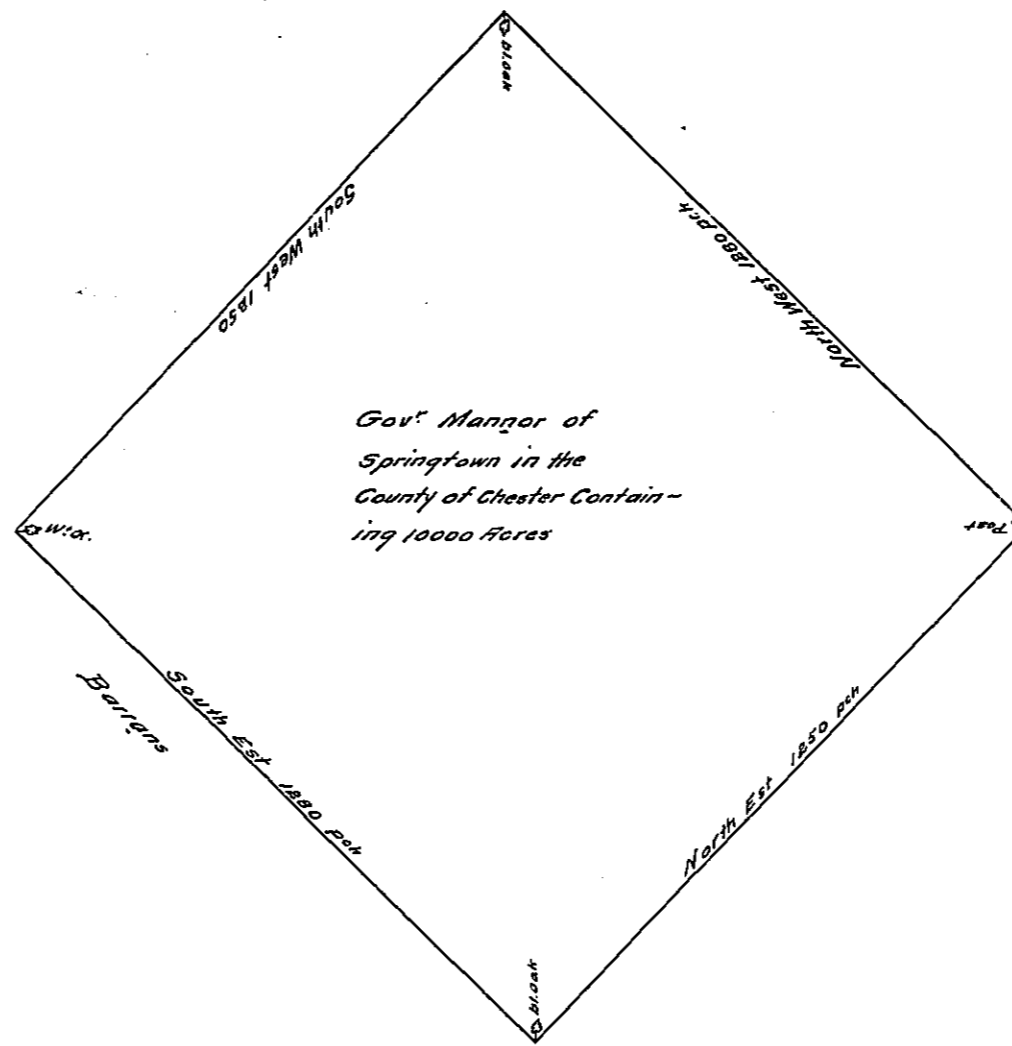

By virtue of An ^{Order} ~~Order~~ from Gov. Penn dated the 30th of ye 7th month 1701 I have surveyed and Laid out for Gov. Penn A Manor celed Springtown in the County of Chester Beginning At a bounded black oak standing on the Est side of the barren Lying on the Est side of Brandywine Creek From thence by a Line of marked trees North Est 1250 pch to A post then by A line N.W. 1280 pch to A Corner marked black oak thence by A Line S.W. 1250 pch to A Corner marked White oak standing on the Edg. of the Aforesd barren then S.E. by ye 5th barren 1280 pch to the place of begining Containing 10000 Acres of Land the 13th 9th 1702

Pr Henry Hollingsworth

(Endorsement on back)
 Springtown Manor
 Copied

30

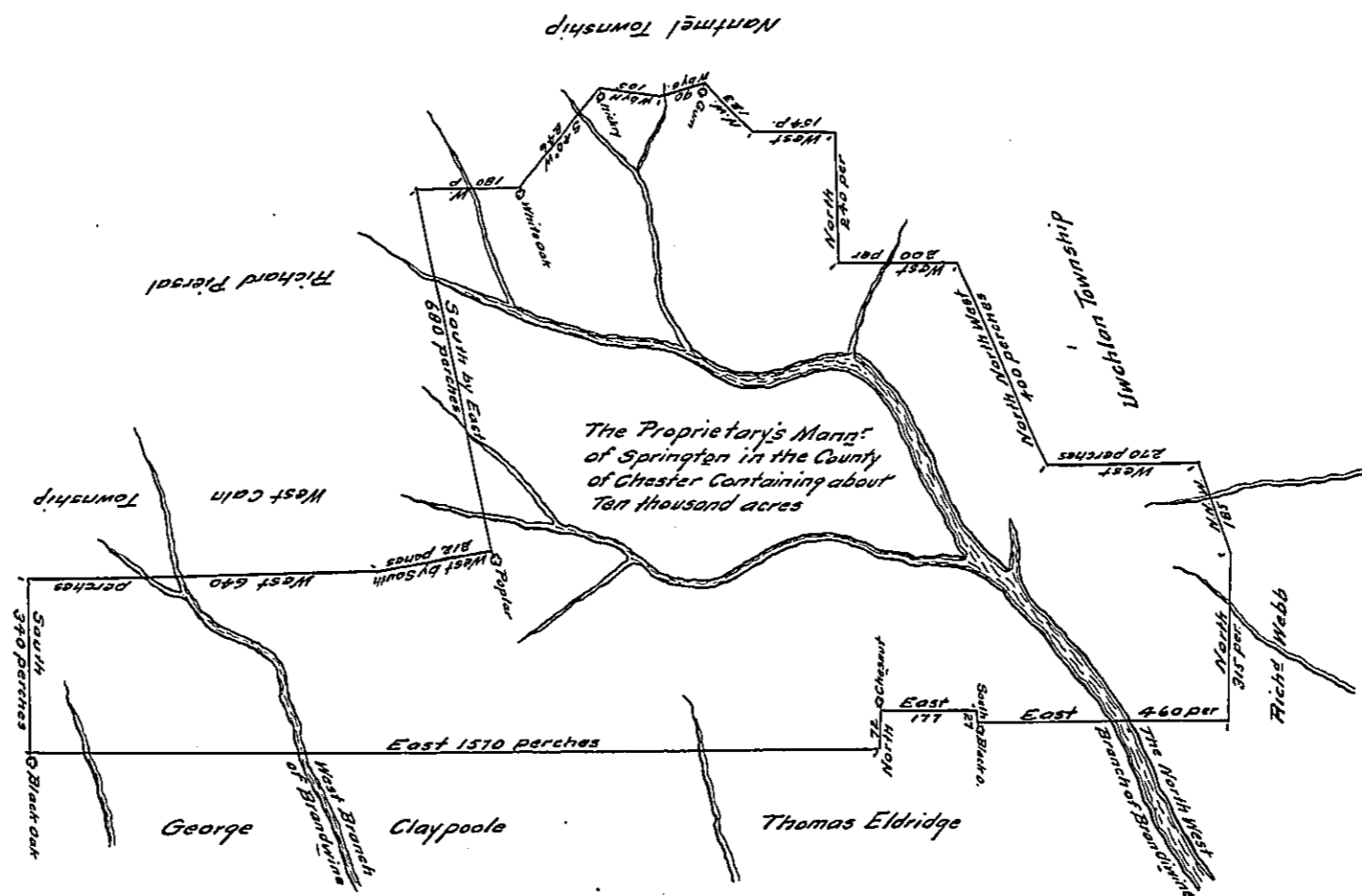

In Testimony, That the above are copies of the originale, remaining on file in the Department of Internal Affairs of Pennsylvania, made conformably to an Act of Assembly, approved the 16th day of February A.D. 1833, I have hereunto set my Hand and caused the Seal of the said Department to be affixed at Harrisburg, this twenty third day of May A.D. 1912.

Henry Houch
 Secretary of Internal Affairs